

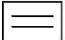

WiFi configuration guide for Android mobile devices

In order to connect to WiFi network at Kozminski University you will need to perform simple configuration, which we described for you in this step-by-step guide.

First step is to turn on device's settings. Different devices with Android OS may have different ways to do this. One way to do it is to use menu button while at main screen. 





If your WiFi card is turned off, turn it on by sliding the bar to the right.

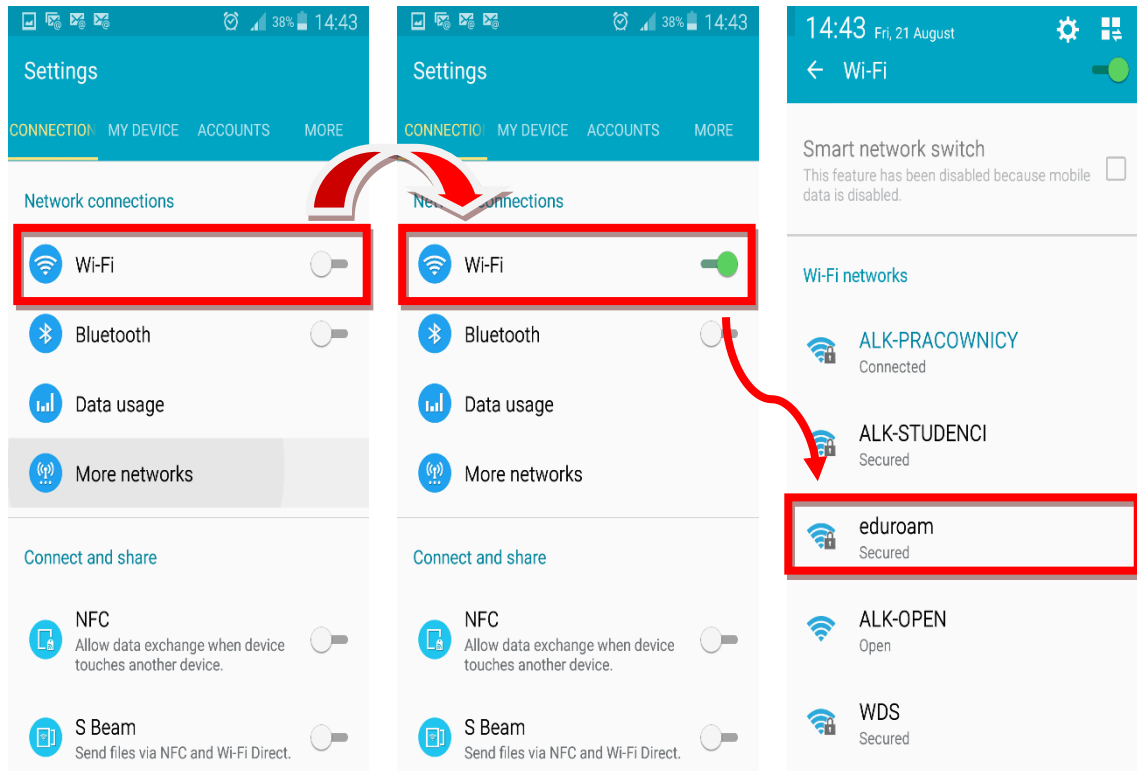

Next, tap WiFi icon. This will allow you to browse a list of available networks. Choose network **eduroam** from the list. In new windows type your credentials as follows:

Identity: your e-mail address from KU (id_number@kozminski.edu.pl).

Anonymus identity: *<remains empty>*

Password: the same password, which you use to login to KU Mailbox or Virtual University.



Make sure, that you selected **PEAP** in **EAP method** field and **MSCHAPV2** in **Phase 2 authentication** field.

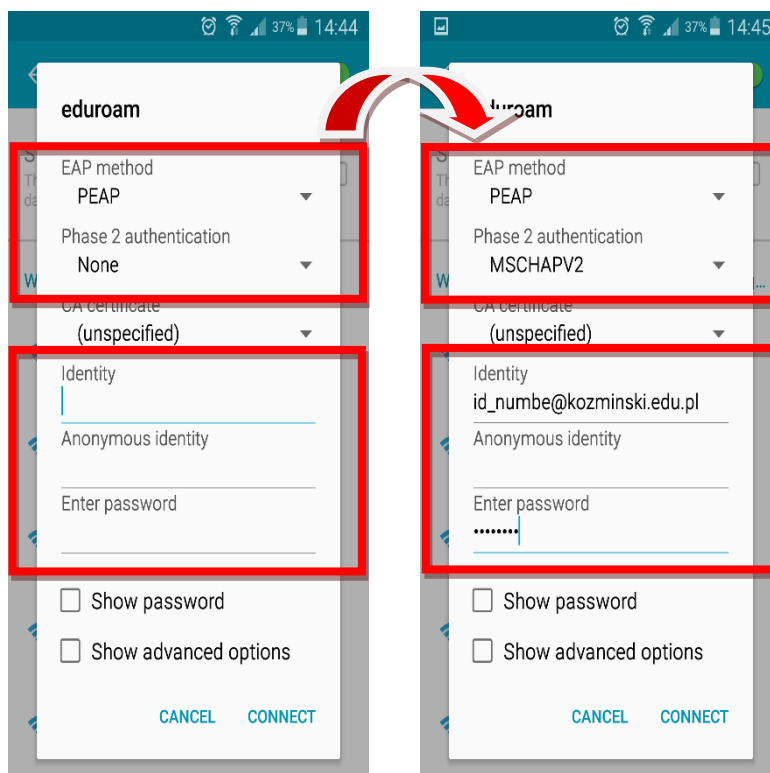

If you checked whole configuration and you entered your credentials, tap **Connect**. From this moment your device will be connected to WiFi network at KU. If you will have problems with connecting your device to the network, please contact *Customer Service and Innovative Solutions Implementation department*.

Email: it@kozminski.edu.pl

Phone: +48 (22) 519-21-45

We are also available in room A115 in following hours:

Monday	Tuesday	Wednesday	Thursday	Friday	Saturday	Sunday
8 am – 6 pm	8 am – 6 pm	8 am – 6 pm	8 am – 7 pm	8 am – 7 pm	8 am – 4 pm	8 am – 4 pm